

AKVA

Air Extractor

01

Water Mattress Valve

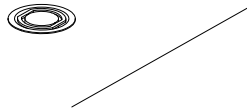

02

Unscrew and remove the waterbed valve cap

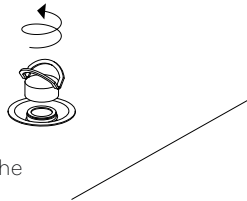

03

Remove the waterbed valve caps

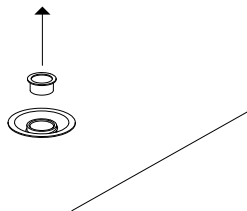

04

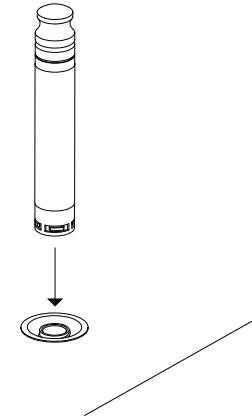

05

Screw the AKVA Air Extractor to the valve

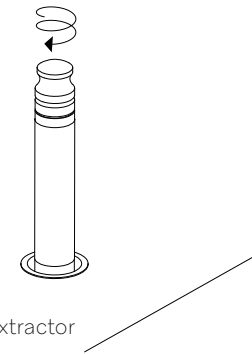

06

Pull the Extractor.
Stop pulling when the Extractor begins to extract water

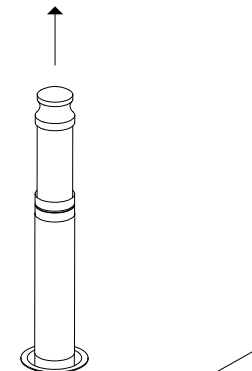

07

Unscrew the pump
from the valve

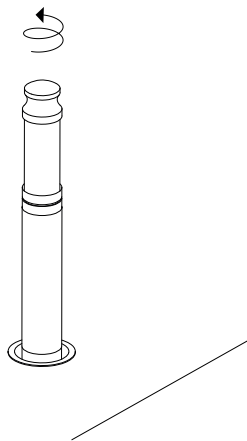

09

Press valve cap
back in place

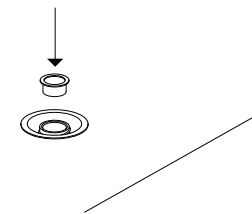

08

Check level of water is
flush with valve

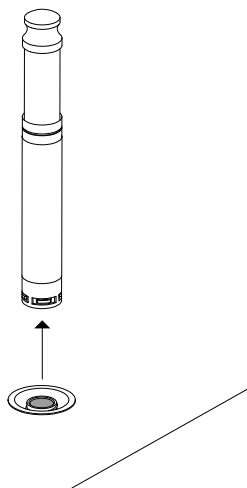

10

Screw valve cap
back in place

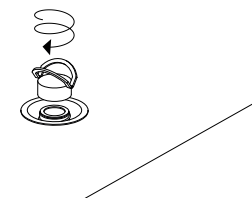

11

